



ARTPLASTICS

Innovative Plumbing Fittings

Hot Water Tray

450mm x 450mm, 500mm x 500mm and 650mm x 650mm

The ribbed base keeps the hot water unit out of direct contact with water, any water is drained away using the Art Plastics Outlet (connects to 40 or 50mm DWV) supplied with the Hot Water Tray.

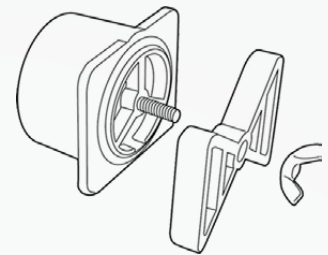

Supplied with Outlet

Available Sizes

- ✓ 450mm
- ✓ 500mm
- ✓ 650mm

New
650mm



Art Plastics

134 Gilba Road Girraween, NSW 2145

Email: sales@artplastics.com.au

Website: www.artplastics.com.au

Phone: 02 9896 7760

Fax: 02 9636 2498

HOT WATER TRAY

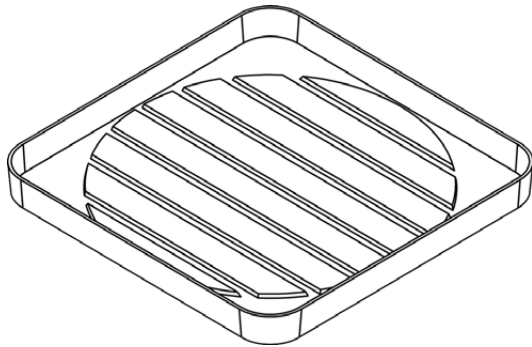

Features include

- ✓ Includes Outlet for connection to 40mm or 50mm pipe.
- ✓ Manufactured from heat resistant PP.
- ✓ Light weight
- ✓ Will not rust, corrode or bend out of shape.
- ✓ Stackable
- ✓ 450mm, 500mm and 650mm sizes.

Product Codes:

34401 - 450mm Black Tray with Outlet

34402 - 500mm Black Tray with Outlet

34404 - 650mm Black Tray with Outlet

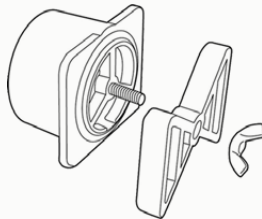

Supplied with Outlet



CONTACT US

■ New South Wales & Victoria

Art Plastics

Phone: 02 9896 7760

Fax: 02 9636 2498

New South Wales

Colin Jay

Phone: 0400 080 591

Victoria

Andrew Molenaar

Phone: 0438 665 444

■ South Australia

Impressions Bathroomware

Phone: 08 8352 8600

Fax: 08 8352 8622

■ Western Australia

Pride Industries

Phone: 08 9272 6511

Fax: 08 9272 3427

■ Queensland & NT

Collis Marketing Services

Phone: 07 3805 6664

Fax: 07 3805 6668

■ Tasmania

Wholesale Products

Phone: 03 6273 3455

Fax: 03 6273 1901