

BOTTLE TRAP 32/40MM

- Suits wall hung basins
- Chrome Plated high quality brass
- Suits 32-40mm waste connection
- Watermark approved
- Standard Finishes: Chrome & Matt Black

Other finishes available upon request including: Polished Brass, Satin Chrome, Gold, Rose Gold and Black Chrome.

CODE	OUTLET SIZE	FINISH	CARTON QTY	FLOW RATE
35102.01	Connects to 32/40mm Trap	Chrome	10	N/A
35102.25	Connects to 32/40mm Trap	Matt Black	10	N/A

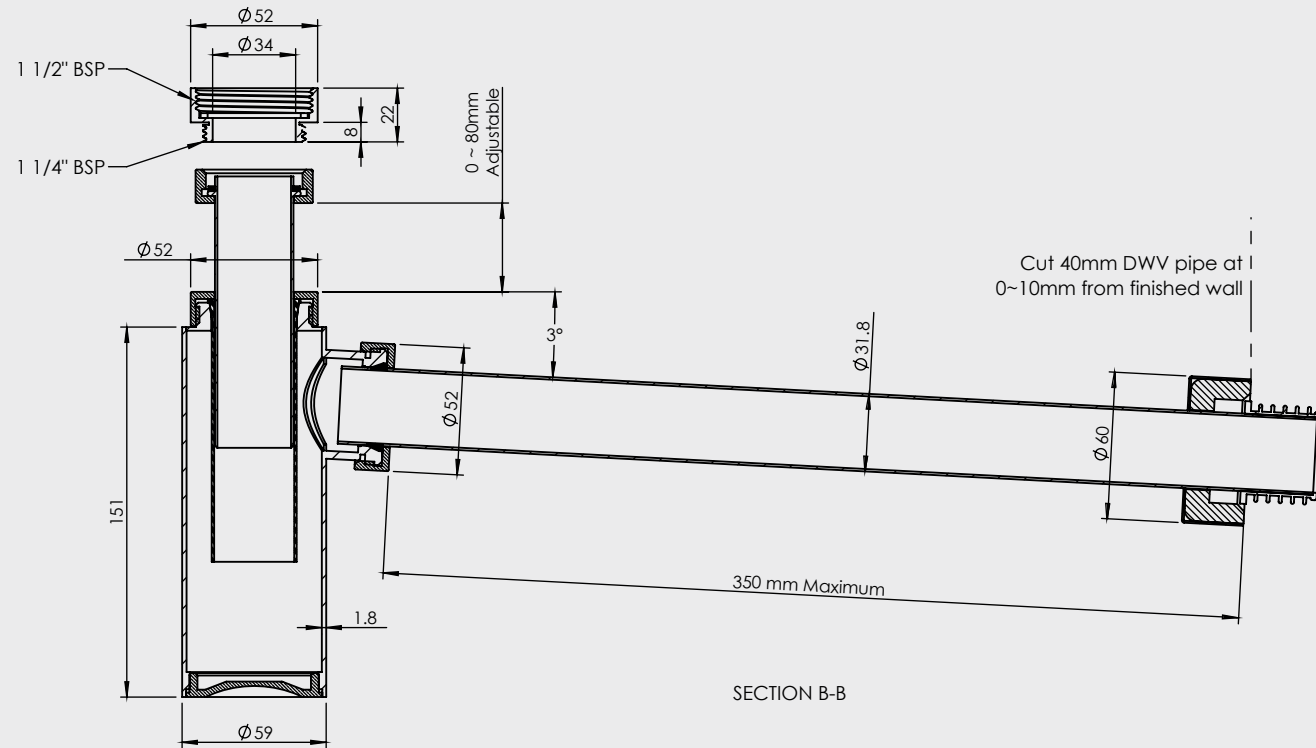

INSTALLATION INSTRUCTIONS

- The Bounty Brassware Bottle Trap can be connected to either a 32 or 40mm plug & waste with the use of the 32 x 40mm Adaptor (1) included.
- The outlet connection of the Bounty Brassware Bottle Trap is designed to connect to 40mm DWV pipe.

1. Apply a lubricant (O-ring lubricant or similar) to the 40mm DWV pipe and the rubber washer (6) inside Outlet Connection Cover Flange (5) to achieve an easy fit.
2. Cut the 40mm DWV pipe to ensure 0-10mm of pipe is protruding from the finished wall or back of vanity cabinet. The pipe should be cut square and chamfered / deburred.
3. To measure the length of the Outlet Tube (4) to be cut attach the Bounty Brassware Bottle Trap to the P/W and insert the Outlet Tube (4) into the 40mm DWV pipe. Mark the point of entry. Remove the Outlet Pipe (4) and add 30mm for the Rubber Seal (7).
4. Push the Outlet Connection Cover Flange (5) assembly onto the Outlet Tube (4). Next push on the Rubber Seal (7). Lubricate the Rubber Seal (7).
5. Push the Outlet Tube (4) into the 40mm DWV pipe until the shoulder of the Rubber Seal (7) is against the pipe. Slide the Outlet Connection Cover Flange (4) over the 40mm DWV pipe until it is flush against the wall.
6. Connect upstream end of outlet tube to the Bounty Brassware Bottle Trap and then reconnect the Bounty Brassware Bottle Trap to the P&W.
7. Use the adjustable inlet tube (2) to set the height of the Bounty Brassware Bottle Trap to achieve sufficient fall in the outlet tube.
8. Ensure bottom screwed plug (8) is tight.
9. Tighten all compression nuts (3) and water test to ensure there are no leaks.

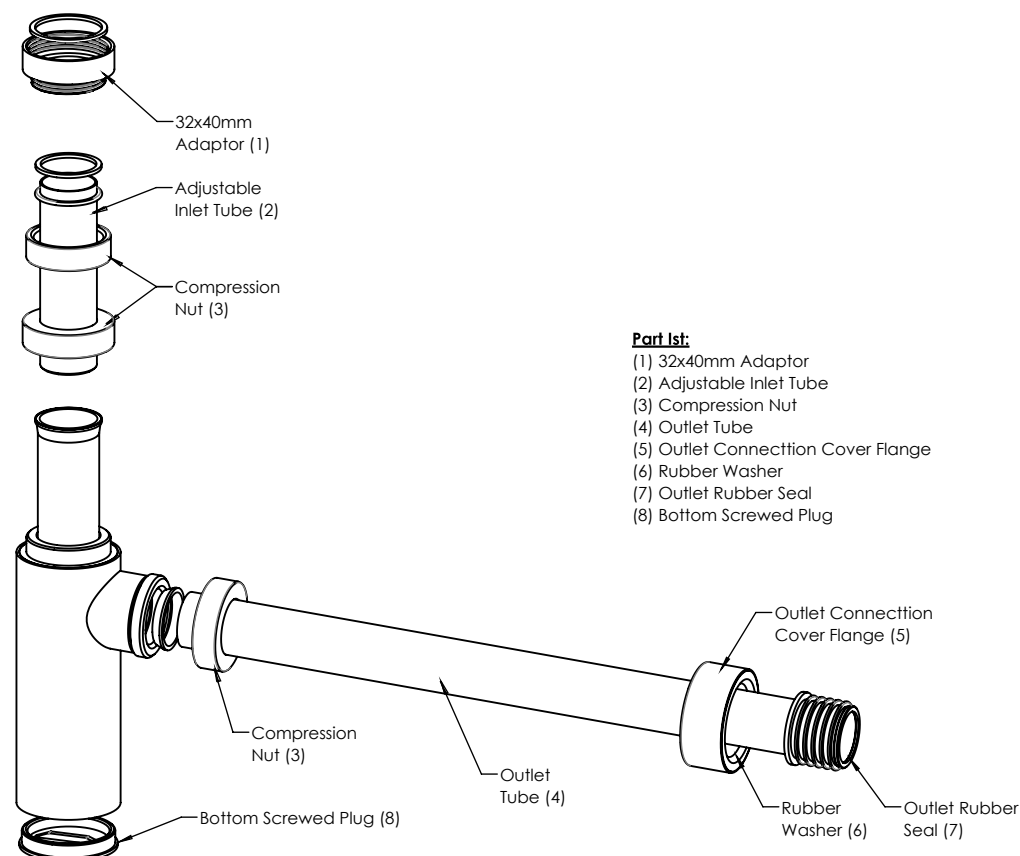

Part list:

- (1) 32x40mm Adaptor
- (2) Adjustable Inlet Tube
- (3) Compression Nut
- (4) Outlet Tube
- (5) Outlet Connection Cover Flange
- (6) Rubber Washer
- (7) Outlet Rubber Seal
- (8) Bottom Screwed Plug

NOTES

Cleaning: Electroplated brass finishes should only be cleaned using a soft cloth and a warm soapy water solution. Surfaces should then be rinsed with clean water and finally dried with a clean soft cloth.

Installation: Bounty Brassware Bottle Trap should only be installed by (or in the presence of) a qualified tradesperson.

All fittings are designed to be hand tightened only.